

2005 - UP MUSTANG CASTER/CAMBER PLATE INSTALLATION INSTRUCTIONS

P/N 340023

***** THIS KIT NOT DESIGNED FOR USE WITH FACTORY STRUT / SPRING SETUP! *****

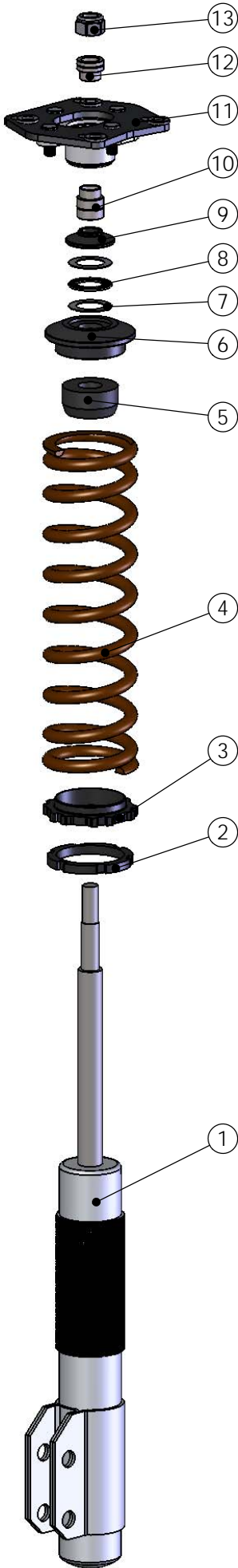

INSTALLATION:

1. Raise front of car with jack and support with jack stands.
2. Remove front wheels and disconnect sway bar end links.
3. Place jack under A-arm and raise up to hold support spindle. Remove strut mounting plate nuts and lower jack allowing strut assembly to drop beneath strut tower. Remove stock strut / spring assembly from spindle.
4. Install new strut assembly onto spindle.

Two different stepped strut spacers are included to optimize strut travel for most applications. Spacers should be positioned so the strut is close to being centered in its travel at ride height. This can be checked by measuring the compressed and extended lengths of the strut and comparing this average to the position of the strut at ride height. Stock applications use the longer spacer (10) on bottom and shorter (12) on top. For most applications with a lower than stock ride height the short spacer should be placed on bottom with the long spacer on top. Check for adequate hood clearance after installation.

Racecraft Inc. caster camber plates have a built-in course camber adjustment. The top of the strut can be moved 3/8" by flipping the plates 180°. This is useful where A-arms are shorter than stock in a race setup and the strut needs to move towards the center of the car.

5. Determine plate orientation and install caster camber plates on strut as shown below. Slide desired lower step spacer onto strut shaft and insert shaft into bearing. Slide upper step spacer on shaft and tighten strut retaining nut. Make sure spacers are properly inserted into spherical bearing!
6. Adjust jack height until plate is slightly below strut tower. Place thick washers between main plate and strut tower and loosely install hardware.
7. Position plates in a neutral alignment position and tighten all hardware securely.
8. Reconnect sway bar end links and reinstall front wheels.

***** DO NOT DRIVE VEHICLE BEFORE BEING REALIGNED! *****

ITEM	DESCRIPTION	QTY
1	STRUT	1
2	ADJUSTING JAM NUT	1
3	SPRING SEAT NUT	1
4	12" COIL OVER SPRING	1
5	BUMP STOP	1
6	TOP SPRING SEAT	1
7	THRUST WASHER	2
8	THRUST BEARING	1
9	STRUT SEAT HAT	1
10	TALL STEP SPACER	1
11	05-UP BASE PLATE	1
12	SHORT STEP SPACER	1
13	STRUT NUT	1

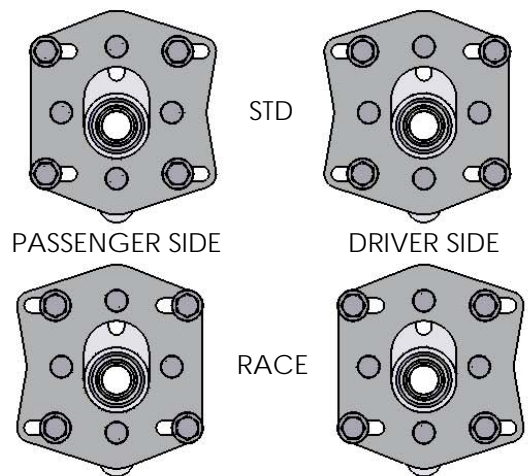

FRONT OF VEHICLE

